



Three Generations of Quality Metal Products

VAN-MET® MODEL FTA-150 - Two Hour Fire-Rated Insulated for Wall or Ceiling Application

manufactured to the **VAN-MET®** design standard



Model FTA-150 wall and ceiling fire-rated panels are manufactured under the factory inspection service of Intertek (Warnock Hersey) and have a label reading: "Listed access frame and insulated fire door assembly **2 hour fire rating. Vertical and Horizontal Installation.** Temperature rise maximum 139° C / 250° F at 30 minutes, 250° C / 450° F at 60 minutes."

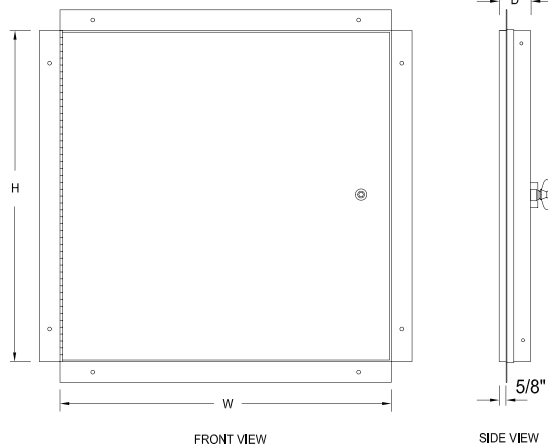

- Designed when control of temperature rise and heat transmission is required in a wall and ceiling application.
- Intertek (Warnock Hersey) tested and lists this door for a two hour fire rating.
- Meets temperature rise requirements for a wall application in the United States at 250° F at 30 minutes and 450° F at 60 minutes. In Canada at 250° C at 60 minutes.
- Standard 16mm (5/8") recessed panel to accept architectural finish of your choice.
- The 16mm (5/8") deep concealed wrap around flange construction makes the frame extremely rigid.
- Exterior appearance is compatible with the non-rated and fire-rated Van-Met access door line, so uniformity of design is maintained when the doors are installed in the same building.

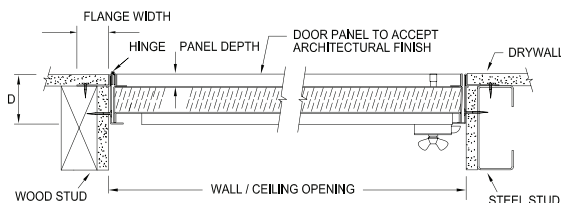

Materials

- Satin finish galvanized steel or 304 2b stainless steel
- Frame - 1.61mm (16ga) steel up to and including 762mm x 1219mm (30" x 48")
- Frame - 1.99mm (14ga) steel greater than 762 mm x 1219mm (30" x 48")
- Panel - 1.31mm (18ga)
- Liner - 0.85mm (22ga)

Insulation

The door panel contains 38mm (1 1/2") of high temperature insulation material between a 1.31mm (18ga) steel panel and a 0.85mm (22ga) steel liner.

Non-Combustibility Classification:

- CAN/ULC S114, ASTM E136
- CAN/ULC S102
- ASTM E84,UL723
- Flame Spread 0
- Fuel Contribution 0
- Smoke Developed 0

Finishes

The paint finish is an electrostatically applied rust inhibitive prime coat or a 2b mill finish stainless steel.

Hinge

The continuous piano hinge allows the door panel to open 175° for easy access. The hinge is placed on the long side of the door ("H" dimension).

Panel Closer

The automatic panel closer will close and latch the door from an open position of approximately 90° as required by code.

All Van-Met® Fire-Rated Access Doors are manufactured to this criteria and do not require any auxiliary springs.

Latch

The standard factory installed latch is a flush mount 1/4" allen key. All fire-rated locks are self-latching and include an interior latch release mechanism allowing the doors to be opened from the inside. The interior latch release is standard on doors including and exceeding 406mm x 406mm (16"x 16"). Under 406mm x 406mm (16" x 16") by request only.

Flange

Concealed flange
Width - 32mm (1 1/4")

Frame Depth

"D" = 73mm (2 7/8")

Panel Depth

16mm (5/8")

Ordering

When ordering, please specify wall or ceiling application. The standard recess on the concealed flange and panel depth are only available in 16mm (5/8"). Please order by rough opening size. These doors are non-returnable.

Installation

The recessed outer concealed flange and inner frame are manufactured with mounting holes. For a square fit, keep the door panel closed while installing. Install before your finishing material is applied.



FOR MORE INFORMATION CALL 1-888-926-1365
 Superior Specialty Supply • 9 Council Drive • PO Box 417 • Woodsboro, MD 21798 • www.sssupply.com