

SUBMITTAL: LP- 5 SAFETY POST FOR LADDERS

The LP- 5 Safety Post provides a convenient and safe method of climbing off and onto fixed access ladders.

Easy to Install: The LP- 5 Safety Post comes pre-assembled and attaches directly to the top two rungs square or round) with two U-shaped bolts.

Easy to Use: When at the top of the ladder extend the safety post. The spring coil allows user to lift with just one hand. Step on or off the ladder in a safe standing position while holding onto the post. A latch maintains the post at variable heights and is easily released for retracting the pole. Pull up loop provided at the top (not for use with safety harness)

Safety features: Include a square post for a no slip grip. We recommend a [Saf-T-Hatch](#) rail system in addition to the Safety Post for greater safety.

Weight: 25 lbs.

Finish: Hot dip galvanized. (See LP-4 for Powder-Coat Painted Safety Yellow Finish)

Compliance:
Meets OSHA 1910.23 (d)(7) grab bars extending 42" above the access level or landing platforms served by the ladder when installed as recommended.

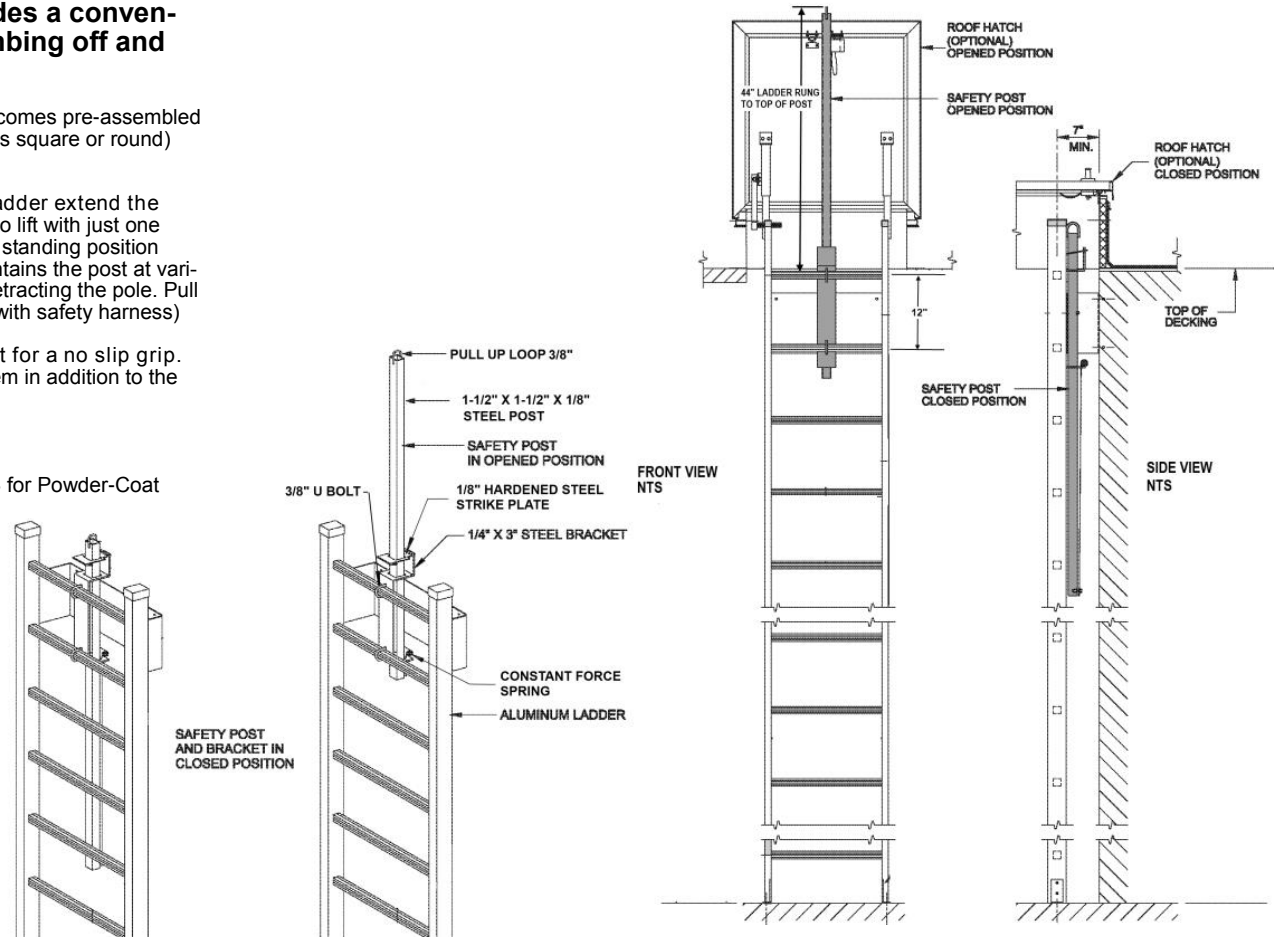

 <p>ACTIVAR INC. CONSTRUCTION PRODUCTS GROUP</p> <p>LP-4 IS A TRADEMARK OF ACPG</p> <p>PLEASE DOWNLOAD MOST CURRENT SUBMITTAL FROM WEBSITE BEFORE ORDERING</p>	Distributor:	Quantity:
	Contractor:	Approved By:
	Model #:	Architect:
	Project:	Date: © 2018 Activar Construction Products Group, Inc.
1/23/2018		



FOR MORE INFORMATION CALL 1-888-926-1365

Superior Specialty Supply • 9 Council Drive • PO Box 417 • Woodsboro, MD 21798 • www.sssupply.com

SUBMITTAL: LP- 5 SAFETY POST FOR LADDERS

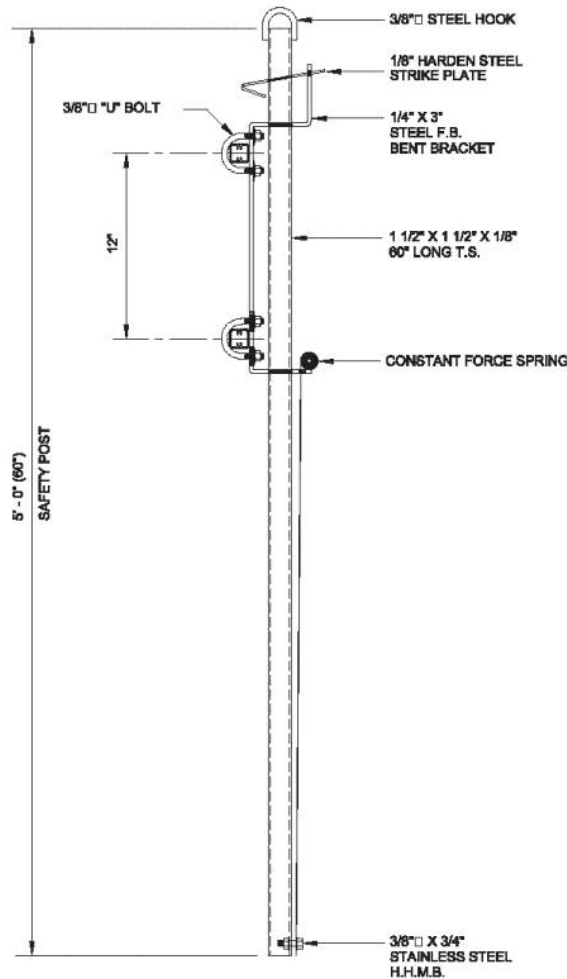

SAFETY POST
1" = 1'-0"

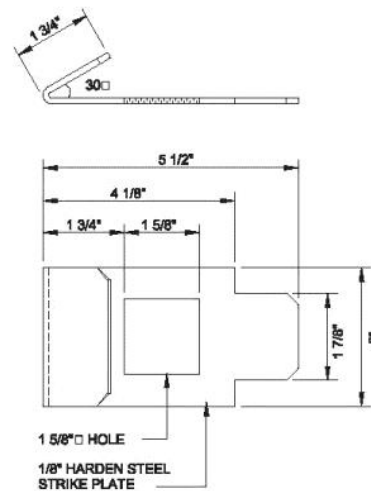

STRIKE PLATE
3" = 1'-0"

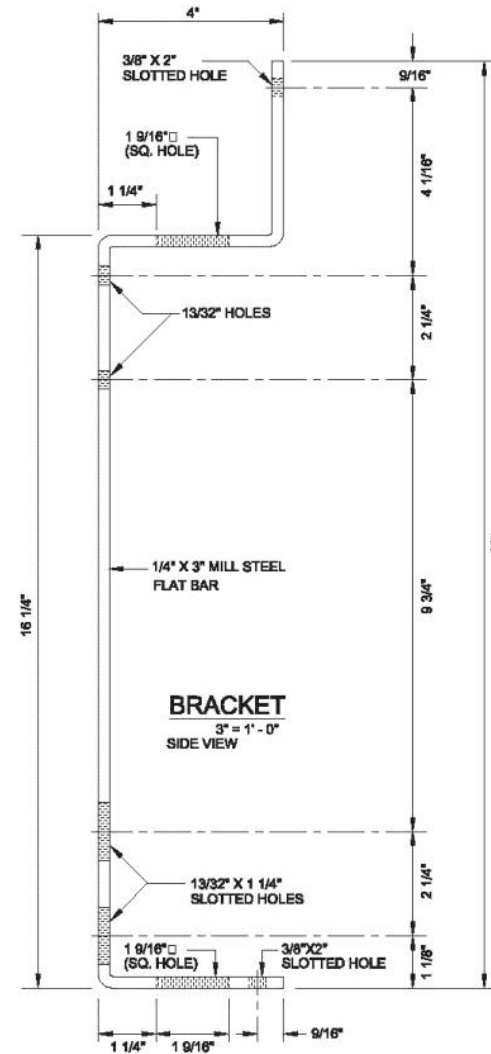

BRACKET
3" = 1'-0"
SIDE VIEW

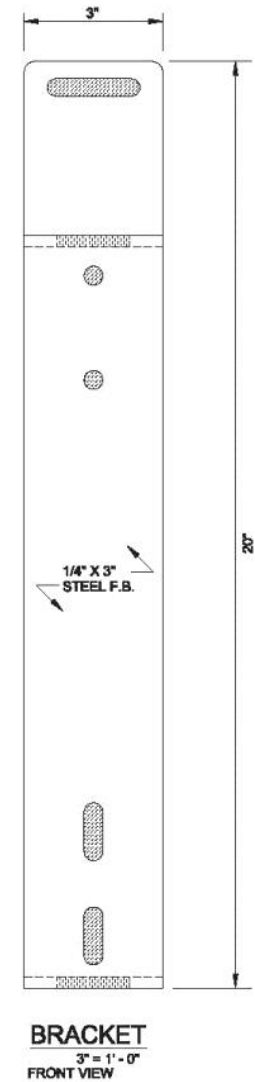

BRACKET
3" = 1'-0"
FRONT VIEW



FOR MORE INFORMATION CALL 1-888-926-1365

Superior Specialty Supply • 9 Council Drive • PO Box 417 • Woodsboro, MD 21798 • www.sssupply.com