



Three Generations of Quality Metal Products

VAN-MET® MODEL FCI-400 - Three Hour Fire-Rated High Temperature, Insulated, Wall or Ceiling Application manufactured to the **VAN-MET®** design standard



Model FCI-400 wall and ceiling fire-rated panels are manufactured under the factory inspection service of Intertek (Warnock Hersey) and have a label reading: "Listed access frame and insulated fire door assembly **3 hour fire rating. Vertical and Horizontal Installation.** Temperature rise maximum 90° C/162° F at 60 minutes."

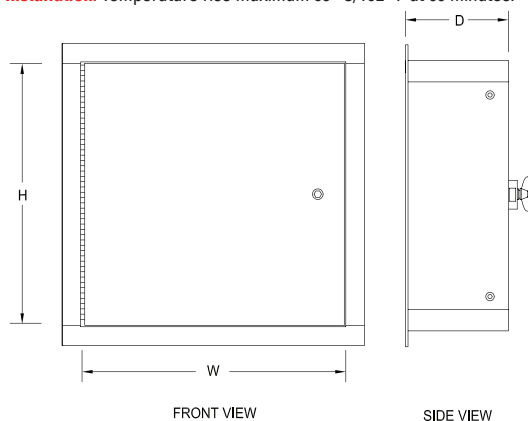

- Designed for use in an electrical shaft wall or ceiling application where control of temperature rise and heat transmission is required.
- Offers protection to junction boxes or at access points in shafts and protects electrical conductors while limiting the temperature rise to less than 90° C/162° F at 60 minutes.
- Tested in both vertical and horizontal positions for the temperature rise.
- The largest net size openings available, making these doors ideal when installation or removal of equipment is a consideration in a fire-rated shaft wall or ceiling.
- Available in any size from 305mm x 203mm (12" x 8") up to 1219mm x 1524mm (48" x 60") for vertical (wall) applications.
- Available in any size from 305mm x 203mm (12" x 8") up to 914mm x 914mm (36" x 36") for horizontal (ceiling) applications.
- Exterior appearance is compatible with the non-rated and fire-rated Van-Met access door line, so uniformity of design is maintained when the doors are installed in the same building.

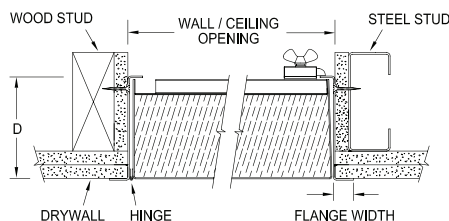

Please note: The key design feature of Van-Met Insulated Access Doors is the protection offered through temperature rise and heat transfer times.

Material

Satin finish galvanized steel
 Frame - 1.61mm (16ga) steel up to and including 762mm x 1219mm (30" x 48")
 Frame - 1.99mm (14ga) steel greater than 762mm x 1219mm (30" x 48")
 Panel - 1.31mm (18ga)
 Liner - 0.85mm (22ga)

Insulation

The door panel contains 102mm (4") of high temperature insulation material between a 1.31mm (18ga) steel panel and a 0.85mm (22ga) steel liner.

Non-Combustibility Classification:

CAN/ULC S114, ASTM E136
 CAN/ULC S102
 ASTM E84,UL723
 Flame Spread 0
 Fuel Contribution 0
 Smoke Developed 0

Finish

The paint finish is an electrostatically applied rust inhibitive prime coat finish.

Hinge

The continuous piano hinge is placed on the long side of the door ("H" dimension).

Panel Closer

The automatic panel closer will close and latch the door from an open position of approximately 90° as required by code.

All Van-Met® Fire-Rated Access Doors are manufactured to this criteria and do not require any auxiliary springs.

Latch

The standard factory installed latch is a flush mount 1/4" allen key. All fire-rated locks are self-latching.

Optional Latch Feature

Interior latch release mechanism available upon request.

Optional Lock

1 1/8" mortise prep complete with mortise cylinder

Optional

1 1/8" mortise prep only

Flange

Exterior flange
 Width - 22mm (7/8") up to and including 914mm x 914mm (36" x 36")
 Width - 32mm (1 1/4") when greater than 914mm x 914mm (36" x 36")

Frame Depth

"D" = 121mm (4 3/4")

Ordering

When ordering, please specify wall or ceiling application. Doors labeled accordingly. Please order by rough opening size.

Note: When specifying or quoting projects, clarify if sizes given are net (clear) openings or rough opening sizes. These doors are non-returnable.

Installation

The door frame is manufactured with mounting holes. All holes must be securely fastened on all four sides.



FOR MORE INFORMATION CALL 1-888-926-1365
 Superior Specialty Supply • 9 Council Drive • PO Box 417 • Woodsboro, MD 21798 • www.sssupply.com