



Three Generations of Quality Metal Products

VAN-MET® MODEL FSD - Two Hour Fire-Rated Uninsulated Security Door for Wall Application

manufactured to the **VAN-MET®** design standard



Model FSD is designed to maintain the continuity of a fire barrier when installed in a **vertical separation**. The assembly is manufactured under the factory inspection service of Intertek (Warnock Hersey) and has a label reading: "Listed access frame and fire door assembly. **2 hour fire rating**. Vertical installation only. No temperature rise rating."

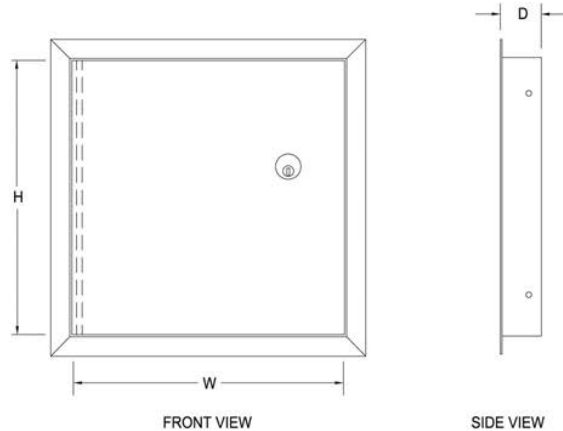

- Designed for use where both fire rating and security are required.
- Manufactured with a 2.75mm (12ga) steel door and a fully welded 2.75mm (12ga) steel frame.
- The continuous rod hinge is welded directly to the frame, making tampering extremely difficult.
- Rod hinge is concealed for a more pleasing appearance.
- For additional security, larger sizes come standard with a panel stiffener.
- Available with brackets for mounting an Anti-Tamper Switch(es).
- Available in any size from 203mm x 203mm (8" x 8") to 1219mm x 1524mm (48" x 60").
- Exterior appearance is compatible with the non-rated and fire-rated Van-Met access door line, so uniformity of design is maintained when the doors are installed in the same building.

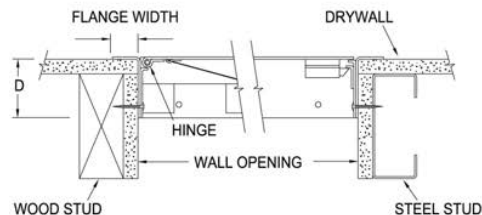

Materials

- Satin finish galvanized steel or 304 stainless steel
- Frame - 2.75mm (12ga)
- Panel - 2.75mm (12ga)

Finishes

The paint finish is an electrostatically applied rust inhibitive prime coat or a No. 4 polished stainless steel finish on the exterior surface.

Hinges

The concealed continuous rod hinge secures the panel and makes tampering with the panel extremely difficult. The hinge is placed on the long side of the door ("H" dimension) unless otherwise requested.

Optional Hinge

Continuous piano hinge

Panel Closer

The automatic panel closer will close and latch the door from an open position of approximately 90° as required by code.

Lock

The standard factory installed latch is a 1 1/8" mortise prep complete with mortise cylinder.

Optional

1 1/8" mortise prep only

Flange

Exterior flange
Width - 32mm (1 1/4")

Frame Depth

"D" = 57mm (2 1/4")

Ordering

Please order by rough opening size. These doors are non-returnable.

Installation

The frame is manufactured with mounting holes. Factory installed anchor straps are available for masonry, upon request.



FOR MORE INFORMATION CALL 1-888-926-1365
 Superior Specialty Supply • 9 Council Drive • PO Box 417 • Woodsboro, MD 21798 • www.sssupply.com